

TYPICAL VERTICAL PANEL JOINT: (SCARF JOINT- 2 PC Panels)

80MM VERTICAL TUBE
CAST IN PC PANEL FOR
1H20 VERTICAL TIE

60N HIGH FLOW
NON-SHRINK GROUT

H20 VERTICAL BAR

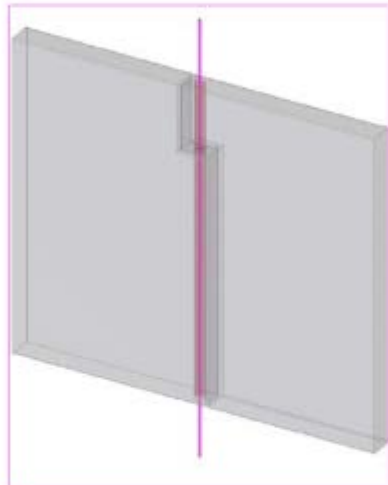
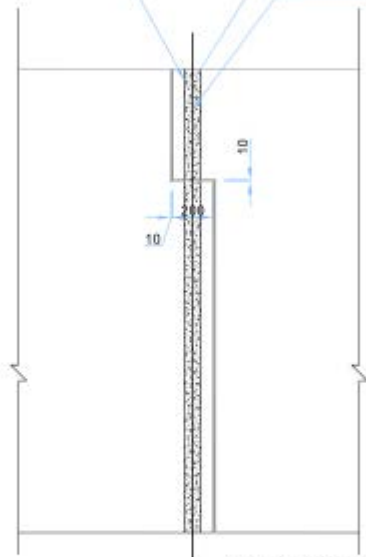

80MM VERTICAL TUBE
CAST IN PC PANEL FOR
1H20 VERTICAL TIE

60N HIGH FLOW
NON-SHRINK GROUT

H20 VERTICAL BAR

